

- 1 étal
- 2 abri de chasse
- 3AB haie verte/coffre
- 4 château
- 5 burglhey
- 6ABC trackenen/tronc/delta
- 7 boussole
- 8ABC cylindre/ch/haie
- 9 barrière anglaise
- 10 ABC tronc/cb/tortue
- 11 maison
- 12 oxer
- PO
- 13 table
- 14AB borne/double brush
- 15ABC haie/haie/haie
- 16 maison
- 17B pointe
- 18 haie verte

PRO 3 / AM ELITE GN 2023

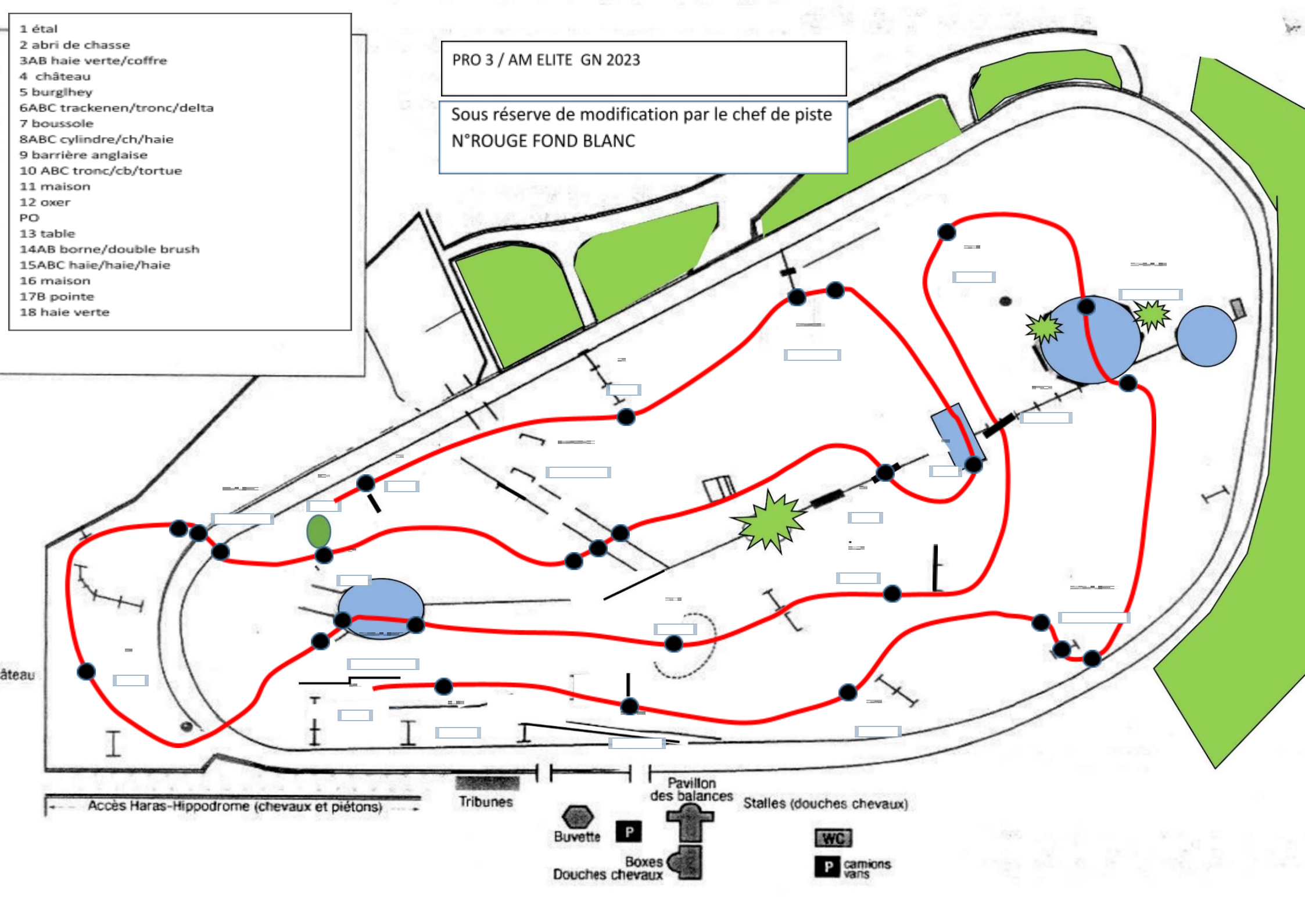





Sous réserve de modification par le chef de piste

N°ROUGE FOND BLANC

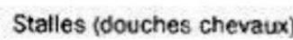

Accès Haras-Hippodrome (chevaux et piétons)

Tribunes

 Buvette
 Pavillon des balances
 Stalles (douches chevaux)
 WC
 P
 Boxes
 P camions vans